

# Domekt CF 200 V C6M

Maximal air flow, m <sup>3</sup> /h	200
Maximal air flow, l/s	56
Reference flow rate, m <sup>3</sup> /s	0,039
Reference pressure difference, Pa	50
SPI, W/(m <sup>3</sup> /h)	0,2
Thermal efficiency of heat recovery, %	92
Electric air heater capacity, kW / Δt, °C	0,5/10,4
Electric preheater capacity, kW / Δt, °C	1/19,6
Supply voltage, V	1~230
Maximal operating current HE, A	8,3
Electric power input of the fan drive at maximum flow rate, W	36
Electric power input of the fan drive at reference flow rate, W	15
Filters dimensions BxHxL, mm	365x132x46
Unit dimensions BxHxL, mm	630x790x595
Maintenance space, mm	600
Unit weight, kg	42

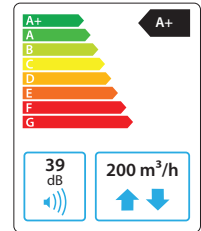

## Acoustic data

A-weighted sound power level  $L_{WA}$ , dB(A) at reference flow rate

Supply inlet	45
Supply outlet	59
Exhaust inlet	42
Exhaust outlet	56
Casing	39

A-weighted sound pressure level  $L_{pA}$ , dB(A)

10 m<sup>2</sup> normally isolated room, distance from casing – 3 m.

Surroundings	28
--------------	----

## Temperature efficiency

Outdoor temperature, °C	Winter					Summer		
	-23	-15	-10	-5	0	25	30	35
After heat exchanger*, °C	18,9*	19,0*	19,0*	19,0*	19,6	22,3	22,9	23,4

indoor +22°C, 20 % RH.

\* calculations made after evaluation of the preheater.

## Shown as right (R1)

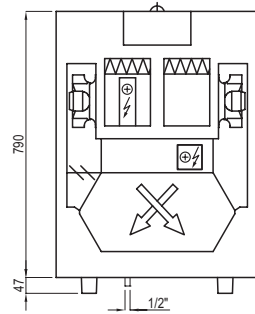

## Shown as left (L1)

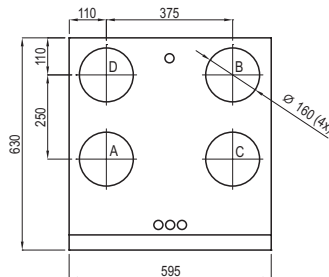

- A outdoor intake
- B supply air
- C extract indoor
- D exhaust air

## Performance

Unit with standard equipment

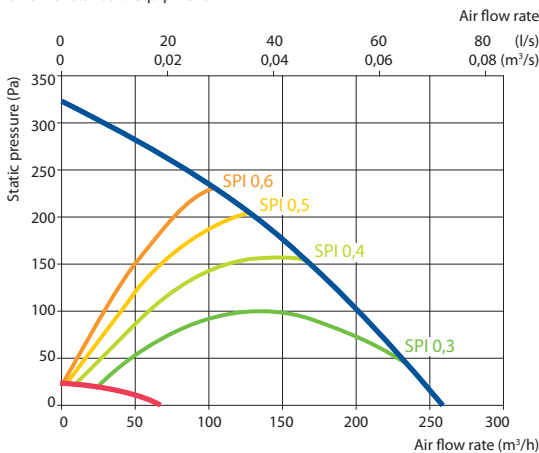

## Accessories

Closing damper	AGUJ-M-160+LF230/CM230
Silencer	A/D AGS-160-50-600-M B/C AGS-160-50-900-M
Water heater	DH-160
PPU	PPU-HW-3R-15-0,4-W2

2-way valve (heater)	VVP47.10-0,25
Water cooler	DCW-0,2-1
2-way valve (cooler)	VVP47.10-1,6
Outdoor grill	LD-160
Water heater-cooler	DHCW-160

